

# town & country REALTORS



serving the unique communities of the beautiful headwaters region



**RE/MAX Real Estate Centre Inc., Brokerage**  
 115 First Street, Orangeville  
 Each office independently owned & operated

**Doug Schild, Broker**  
**Chris Schild, Sales Representative**  
**Laura Leach, Sales Representative**



**Office: 519-942-8700 1-800-461-2686**  
**Email: info@therealestatemarket.com**

[www.therealestatemarket.com](http://www.therealestatemarket.com)

Est. 1992

**\$649,000**



**FLAIR**  
 1/2 acre, private, lot w/large pool, B/I appliances and stiletone counter top. Master comes with large walk-in closet and an amazing 5 piece ensuite. Main floor theatre room and much more.

**\$599,900**



**PERFECT COUNTRY LIVING**  
 Private log home located on 20 acres in the heart of Mono. This unique home features large foyer, bright spacious kitchen with antique cookstove, wood floors and multiple walkouts. The upper level has 6 bedrooms, with balcony off master. Property has inground pool, large bank barn, open meadow and mature bush.



**CREAM OF THE CROP**  
 297 acres for large farming parcel. This property also features a well maintained 2 storey home, main bath with whirlpool tub & separate shower. It also features a 1100 sq. ft. pole barn, original bank barn, drive shed, heated workshop with 14ft & 12ft doors, implement shed with 14ft doors and multiple out buildings. There is approximately 240 acres of workable land.

**\$339,900**



**SHOWS LIKE A MODEL**  
 This immaculate well maintained home features new kitchen with ceramic floor, corian counters & custom lighting. Hardwood floors on main level, access to garage from foyer. Master bedroom with 4 pc. ensuite and walk-in closet. Fully finished walkout basement with gas woodstove and cold cellar. Fenced yard and interlock walkway and driveway.

**\$1,250,000**



**FARMERS PARADISE**  
 Rare opportunity for a 200 acre farm in Amaranth. Land and buildings have been well maintained over the years. Property features a 2-Storey Stately farm house, cattle barn 75 ft. X 104 ft., steel driveshed 40 ft. X 80 ft., two 70 foot silos and several steel grain storage bins. Home features attached double garage, 4 bedrooms, spacious kitchen and propane fireplace in the family room.



**\$10.00 PER SQ. FT. - PRIME LOCATION**  
 This 3000 sq ft Multi-Use building is visible from County Rd 124. There is 250 sq ft reception area, 210 sq ft office area and balance of area is 3 bay garage. The loft storage is approximately 300 sq ft., small lunch room/kitchenette and two bathrooms.

**\$529,900**



**IDEAL SETTING FOR ENTERTAINING**  
 6.8 acres with mature evergreens & great views. Beautiful new 3 bedroom bungalow with walkout basement. Main floor features spacious kitchen/great room with walkouts to large rear deck, main floor den & laundry room with garage access & much more.

**\$289,900**



**STUNNING MULTI-LEVEL**  
 This home has been completely customized with stately front entrance, dark hardwood floors on main level, eat-in kitchen with built-in appliances, main floor laundry with walkout to yard. 3 generous bedrooms with loads of storage & built-ins, finished basement with gas fireplace, separate office. Mature yard with custom shed.

**\$364,900**



**ENDLESS POSSIBILITIES**  
 10 acres situated on a paved road just 5 minutes from Orangeville, private setting, pond, 2 storey home, 4 bedrooms, 4 bathrooms, double car garage, small barn.



**MAKE YOUR DOLLARS WORK**  
 Great opportunity in Orangeville's industrial sector. This 9,500 sq. ft. clear span steel building, presently set up with 1,800 sq. ft. of office space with Mezzanine storage above and 7,800 sq. ft. of open industrial area for the balance of the building. The building is fully insulated.

**\$549,900**



**CHARACTER AND CHARM**  
 This great classic 2 storey Cape Cod features country kitchen open to family room which features maple cabinetry, centre island with walkout to large rear deck. Birch floors through main and upper level, foyer open to second floor, master bedroom features walk-in closet and luxurious ensuite. Loft could be great studio/inlaw suite.

**\$269,900**



**IN TOWN BEAUTY**  
 Great commuter location and close to schools. This spacious 2-storey home features ceramic foyer, bright principal rooms on main level with hardwood and ceramic floors. Eat-in kitchen has walkout to rear yard, family room with gas fireplace. Four bedrooms on second level, large master with his/hers closets and 4pc ensuite bathroom.

**\$262,900**



**ENTERTAIN IN STYLE**  
 This is a beauty! All brick 2 storey home with open concept bungalow. Hardwood flooring on main level, living room is breathtaking with roaring cathedral ceiling and fireplace. Master bedroom on main floor with walk-in closet and ensuite bath.



**GREAT STARTER HOME**  
 Check out this 3 bedroom semi home in good commuter location. Features spacious living/dining room combined with large front window, eat in kitchen with walkout to deck and fenced yard. Lower level finished and features recreation room guest room and 2 pce. powder room.

**\$269,900**



**COUNTRY LIVING**  
 Great for entertaining. This well maintained home features large principal rooms, 3 bedrooms, main floor family room has gas fireplace. Laundry room on 2nd floor for convenience with walkout to deck. Oversized garage ideal for workshop.

**\$189,900**



**10 ACRE BUILDING LOT**  
 Great opportunity for a 10.4 acre parcel of land just minutes South of Shelburne. This beautiful treed lot will provide a private site for building your dream home. Possibility of pond site at front of property.

**\$285,000**



**IT'S ALL ABOUT LIFESTYLE**  
 This stunning 4 bedroom home offers main floor family room with fireplace, crown moulding throughout, walkout to fenced yard with new deck. The basement offers extensive storage areas and large open concept rec room. Located close to school, hospital and Island Lake Conservation.



**BUILD YOUR DREAM HOME**  
 Opportunity to build on this 5 acre lot with two road frontages and located on paved road. The lot is bordered with mature evergreens providing a beautiful setting.

**\$420,000**



**OUT, BUT NOT "FAR OUT!"**  
 Located west of Orangeville on a paved road. Traditional raised bungalow with double car garage and situated on approximately 5 acres features 3 bedrooms, large principal rooms on the main level, bright country kitchen with oak cabinets, walkout basement partially finished with 2 additional guest rooms. Laundry area has walkout.

**\$399,900**



**CHARM OF YESTERYEAR**  
 Rare opportunity for a stately century home on a huge lot. Features 4 bedrooms, large eat-in kitchen with main floor laundry. Huge mudroom that walks out to rear deck, play area and fenced yard. Back lane access to insulated, detached single car garage plus detached and insulated triple car garage/workshop.

**\$349,900**



**IDEAL LOCATION**  
 Beautiful 29 acre parcel of land located in Mono Township, west of the Hamlet of Camilla, well treed with a clearing near the rear where the property elevation is high and has great views to the south and west. Lots of privacy and great location for commuting.



**ENTERTAIN IN STYLE**  
 Inside and out this home has been finished with great attention to detail. Features spacious open concept kitchen/dining area, breakfast counter, walkin pantry and slate backsplash. Great rear yard with covered patio, large shed and backs onto park. Master bedroom has his/hers closets, ensuite with whirlpool tub! All this plus finished basement.

**\$229,900**



**CUL-DE-SAC LOCATION**  
 This 2 storey, 3 bedroom home features convenient front entrance/mudroom, galley kitchen, bright dining room with walkout to rear deck and fenced yard. Basement has finished rec room with storage area.

**\$219,900**

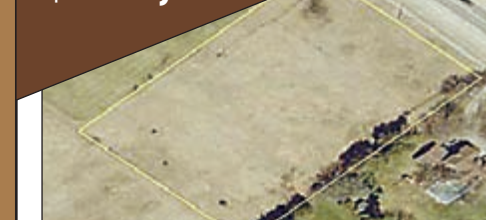

**HIGHWAY LOCATION - CALEDON**  
 Lovely 1.7 Acres fronting on the west side of Highway 10 at the south end of Caledon Village. Property is level and open.